



**170 Osborne Road Mitchelton QLD**

3  2  1 

This fantastic home is located in the trendy and popular suburb of Mitchelton. With so many features and at such a great price a home like this is hard to come by.

**View :** <https://www.aumr.com.au/1P0541>

**Features:**

- 3 Large bedrooms with built-in robes and reverse-cycle air-conditioning,
- Master featuring walk in wardrobe
- Spacious living room
- Huge separate dining room
- Modern sized kitchen with plenty of bench space, gas stove and dishwasher
- Large main bathroom with separate shower and spa bath and double vanity
- Generous second bathroom
- Plenty of storage space throughout
- Large laundry

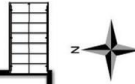

\* All floor plan details are for information purposes only. The measurements and layout displayed are approximate.